

DIAGRAM

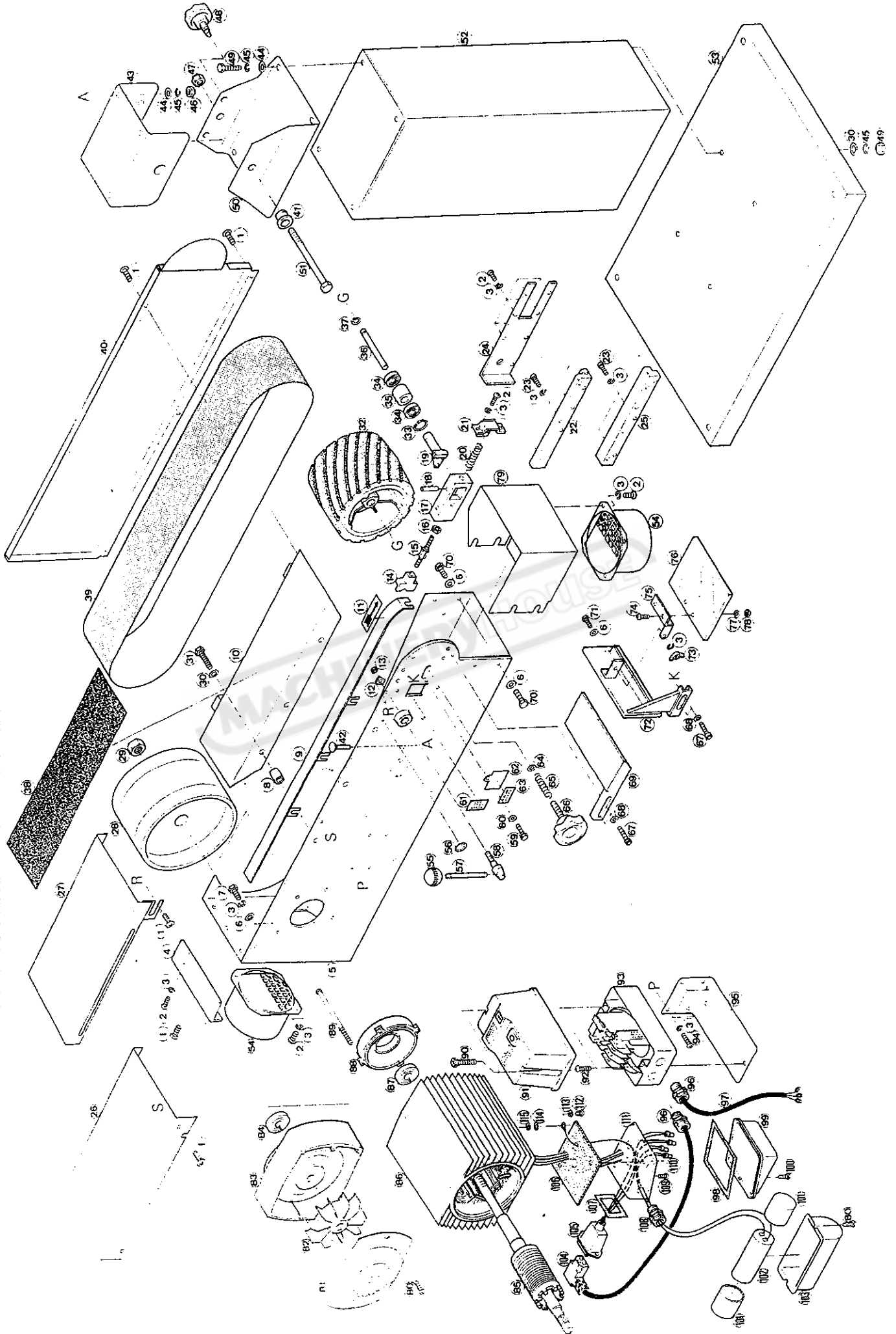

# PARTS LIST

REF. NO.	PARTS NAME
1	Screw
2	Screw
3	Spring Washer
4	Dust Proof Cover
5	Base
6	Washer
7	Hex. Bolt
8	Bush
9	Dust Proof Plate
10	Belt Support
11	Arrow Mark
12	Cam
13	Hex. Nut-Looseproof
14	Press Block
15	Adjusting Rod
16	Hex. Nut
17	Sliding Block
18	Pin
19	Adjusting Block
20	Spring
21	Spring Stop Plate
22	Upper Support
23	Cap Screw
24	Block Stop Plate
25	Lower Support
26	Fixed Cover
27	Sliding Cover
28	Aluminum Roller
29	Hex. Nut

REF. NO.	PARTS NAME
30	Washer
31	Hex. Bolt
32	Rubber Roller
33	Snap Ring
34	Ball Bearing
35	Bush
36	Shaft
37	Snap Ring
38	Graphite Packing
39	Sanding Belt
40	Protection Cover
41	Bush
42	Square Neck Bolt
43	Upper Bracket
44	Washer
45	Spring Washer
46	Hex. Nut
47	Hex. Nut
48	Positioning Knob
49	Hex. Bolt
50	Lower Bracket
51	Hex. Bolt
52	Stand
53	Bottom Plate
54	Chip Outlet
55	Ball Knob
56	Loosen-Tighten Plate
57	Screw Shaft
58	Cam Shaft

REF. NO.	PARTS NAME
59	Cover Screw
60	Wave Washer
61	Adjusting Plate
62	Cover
63	Cover Plate
64	Washer
65	Spring
66	Tracking Knob
67	Cap Screw
68	Washer
69	Working Table
70	Hex. Bolt
71	Hex. Bolt
72	Sanding Stop Plate
73	Wing Nut
74	Screw
75	Support Plate
76	Eye Shield
77	Washer
78	Hex. Nut
79	Dust Collector
80	Screw
81	Rear Protector
82	Fan
83	Rear Support
84	Ball Bearing
85	Rotor
86	Stator Housing
87	Ball Bearing

REF. NO.	PARTS NAME
88	Front Support
89	Screw
90	Screw
91	Switch Box Cover
92	Screw
93	Switch Box
94	Screw
95	Supporting Plate
96	Strain Relief
97	Power Cord
98	Packing
99	Wiring Box Cover
100	Screw
※101	Capacitor Sleeve
※102	Running Capacitor
※103	Capacitor Cover
104	Plug
105	Plug Socket
106	Packing
107	Packing
※108	Strain Relief
109	Screw
110	Wire Connector
111	Wiring Box
112	Screw
113	Int. Washer
114	Copper Set
115	Ext. Washer

※ Parts No. 101,102,103,108 for 1 phase electricity only.